



High Frequency(Hybrid-ECO)-Single

CB IV3624HEH / CB IV6048HEH

Features

- UPS Powerful bypass function.
- Overload, short circuit, over discharge protection.
- Grid-tied, off-grid and grid-tie with backup.
- AC/Solar input priority selectable.
- Compatible with lithium & lead acid battery.
- Cold start, BMS active equalization.

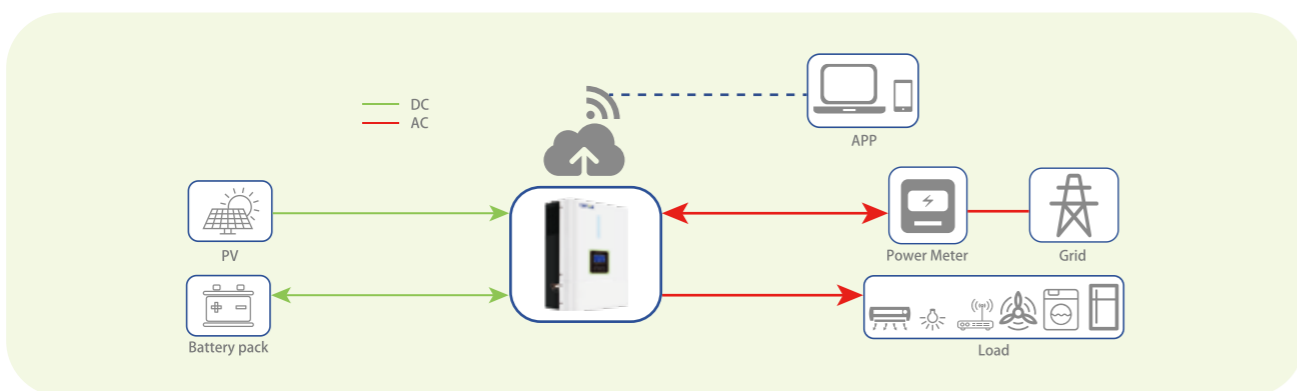

| MODEL | CB IV3624HEH | CB IV6048HEH |
|-----------------------------------|---|--------------|
| Rated Power | 3600W | 6000W |
| AC OUTPUT (GRID) | | |
| Nominal output voltage | 220/230/240 VAC | |
| Voltage Range | 184 - 264.5 VAC or 195.5 - 253 VAC (Selectable) | |
| Nominal output Current | 14.5A | 26.1A |
| Power Factor | > 0.99 | |
| Max.Conversion Efficiency (DC/AC) | 95% | |
| Output Waveform | pure sine wave | |
| AC INPUT | | |
| Input Voltage Range | 90 - 280 vAC or 170 - 280 vAC | |
| Frequency | 50 Hz/60 Hz (Auto sensing) | |
| Max. AC Input Current | 40A | |
| Efficiency (DC to AC) | 93% | |
| BATTERY | | |
| Norminal Voltage | 24 VDC | 48 VDC |
| Max.Charge Current | 120A | 120A |
| Max.AC Charge Current | 100A | 100A |
| Max. Charge Current | 120A | |
| Battery Type | Lead-acid/Lithium | |
| PV INPUT | | |
| Max. Pv Array Power | 4000W | 6500W |
| Max.PV open Circuit Voltage | 500 VDC | |
| MPPT Voltage Range | 60vdc-450vdc | |
| MPPT Tracker Number | 1 | |
| GENERAL | | |
| Communication Port | USB/RS232/RS485/WIFI | |
| Humidity | 0 ~ 90% RH (Non-condensing) | |
| Operating Temperature | -10 °C to 50 °C | |
| Net Weight (kg) | 8.7 | 10.6 |
| Dimension, D x W x H (mm) | 128*300*363 | |